

GCB Risk Assessment

Goal - Minimise risk of transmission of COVID-19 during Sunday meetings or other meetings held corporately at Crofton Park Baptist Church.

Risk Assessment Matrix from The Baptist Union in Collaboration with Crofton Park Baptist Church

The following tables give a framework for assessing the risks identified, with some guidance to assist you with what a score might mean. The scoring system deliberately places additional emphasis on risks with the most severe consequences but are not very likely over those that are likely but have limited consequence. This aligns with the most recent best practice in assessment and management of risks.

In the Coronavirus pandemic, it is likely that most risks, before controls are implemented will be scored as 5 (high probability) and 5 (high severity) as the likelihood of a case being observed within 12 months is significant and the consequences are potentially death of an individual or multiple individuals. This goes to emphasize the importance of taking control measures seriously in order to reduce the likelihood and severity of the risk.

Likelihood / Probability
5. Likely to occur at least once in any 12 month period
4. Likely to occur at least once in a 3 year period
3. Likely to occur at least once in a 10 year period
2. Likely to occur at least once in a 50 year period
1. Unlikely in a 50 year period

Severity / Significance / Consequence
5. Expected to result in church closure or significant harm to multiple individuals, death of an individual
4. Material threat to continued existence of church, or significant harm to single individual
3. Substantial adaptation required to ongoing operations
2.. Minor adaptation required to ongoing operations
1. Inconvenience to ongoing operations

RISK / PRIORITY INDICATOR MATRIX						
LIKELIHOOD / PROBABILITY	5	7	14	21	28	35
	4	6	12	18	24	30
	3	5	10	15	20	25
	2	4	8	12	16	20
	1	3	6	9	12	15
		1	2	3	4	5
		SEVERITY / SIGNIFICANCE / CONSEQUENCE				

Score = Severity x Likelihood + 2 x Severity
(this formula places additional emphasis on high severity issues)

Summary		Suggested Timeframe for Action
20+	High	Immediate / within days
15-19	Medium	Within weeks
1-15	Low	Whenever viable to do so

The Environment: Main Meeting Room and entrance toilets which will be used for our corporate church service

Risk Identified and Measured	Control Measures	Review Date														
<p>1. 60+ Adults and Children meeting in a space where Covid-19 Transmission is a High Risk through:</p> <p>i) Person to person contact where ‘Social distancing’ is compromised</p> <table border="1" style="width: 100%; border-collapse: collapse; margin-bottom: 10px;"> <tr> <td rowspan="3" style="width: 20%;">Risk Rating before control measures</td> <td style="width: 20%;">Likelihood</td> <td style="width: 10%; text-align: center;">5</td> </tr> <tr> <td>Severity</td> <td style="text-align: center;">5</td> </tr> <tr> <td>Overall Risk</td> <td style="text-align: center; background-color: #f08080;">35</td> </tr> </table> <table border="1" style="width: 100%; border-collapse: collapse;"> <tr> <td rowspan="3" style="width: 20%;">Risk Rating after control measures</td> <td style="width: 20%;">Likelihood</td> <td style="width: 10%; text-align: center;">3</td> </tr> <tr> <td>Severity</td> <td style="text-align: center;">4</td> </tr> <tr> <td>Overall Risk</td> <td style="text-align: center; background-color: #90ee90;">12</td> </tr> </table> <p>Main Hall capacity estimated at 50 GCB people when bubbled</p>	Risk Rating before control measures	Likelihood	5	Severity	5	Overall Risk	35	Risk Rating after control measures	Likelihood	3	Severity	4	Overall Risk	12	<p>Social Distancing</p> <ul style="list-style-type: none"> Those in the following categories will be instructed to stay at home: <ul style="list-style-type: none"> - current COVID-19 symptoms, - COVID-19 symptoms that started within the past 10 days, - positive COVID-19 test within the past 10 days, - family member had symptoms that started within the past 14 days, - family member had positive COVID-19 test within 14 days. No physical contact between those in different households (except where “bubbled together”) Numbers will not exceed 50 - capacity for safe social distancing. Congregation will wear face masks (exceptions: 11 yrs or younger; health condition, during communion) Disposable masks are available for those who have forgotten. The leader, preacher, reader, prayer do not always need to wear a face covering. There is a one-way system: the main front is the entrance, the carpark door is the exit. Entry and Exit are clearly marked with arrows and signs. Potential queue locations have social distancing markers on the floor Weekly ‘Stewards’ will direct entry and exit and seating of congregation at least 1m distance Seating is arranged in family/household/bubble groups. Groups will be asked to avoid facing towards each other Where possible, doors and windows will be kept open throughout meeting Clear signage and verbal notices will be used to remind everyone of safe practices 	<p>1 Oct 2020</p>
Risk Rating before control measures		Likelihood	5													
		Severity	5													
	Overall Risk	35														
Risk Rating after control measures	Likelihood	3														
	Severity	4														
	Overall Risk	12														
<p>ii) Touching contaminated surfaces</p>	<p>Cleaning</p> <ul style="list-style-type: none"> A “cleaning team” will wipe down all surfaces identified on a Checklist before and after the meeting. All soft furnished seating has been removed and stored elsewhere Plastic chairs from back hall have been relocated to the main room. Main areas have been cleared of all unnecessary furniture, books, toys and equipment The Kitchen and Prayer Lounge are currently out of bounds. If cleaning an area used by someone with Covid-19 symptoms there is a GCB guideline that will be followed. 	<p>1 Oct 2020</p>														

<table border="1"> <tr> <td rowspan="3">Risk rating before control measures</td> <td>Likelihood</td> <td>5</td> </tr> <tr> <td>Severity</td> <td>5</td> </tr> <tr> <td>Overall Risk</td> <td>35</td> </tr> </table> <table border="1"> <tr> <td rowspan="3">Risk Rating after control measures</td> <td>Likelihood</td> <td>3</td> </tr> <tr> <td>Severity</td> <td>4</td> </tr> <tr> <td>Overall Risk</td> <td>12</td> </tr> </table>	Risk rating before control measures	Likelihood	5	Severity	5	Overall Risk	35	Risk Rating after control measures	Likelihood	3	Severity	4	Overall Risk	12	<p>Hand Sanitising</p> <ul style="list-style-type: none"> • Hand Sanitising Stations are available at entry and exit Points • Everyone will be asked to use hand sanitiser on arrival and exit • Signs and posters are on display to build awareness of hygiene; <p>Toilet Facilities</p> <ul style="list-style-type: none"> • Toilets are restricted to one person/family in and one out • Toilet main entry doors will remain open with a 'privacy screen' in front of men's toilet (urinal) • Everyone will be asked to spray clean/wipe toilet after use • An area for queuing at Social Distance is marked out • Hand Sanitising Stations are available outside toilets • Children under 11 should be accompanied by an adult and assisted with hygiene needs • Signage provides instructions on one in/one out and on hygiene 	
Risk rating before control measures		Likelihood	5													
		Severity	5													
	Overall Risk	35														
Risk Rating after control measures	Likelihood	3														
	Severity	4														
	Overall Risk	12														
<p>iii) Airborne Transmission</p> <table border="1"> <tr> <td rowspan="3">Risk Rating before control measures</td> <td>Likelihood</td> <td>5</td> </tr> <tr> <td>Severity</td> <td>5</td> </tr> <tr> <td>Overall Risk</td> <td>35</td> </tr> </table> <table border="1"> <tr> <td rowspan="3">Risk Rating after control measures</td> <td>Likelihood</td> <td>3</td> </tr> <tr> <td>Severity</td> <td>4</td> </tr> <tr> <td>Overall Risk</td> <td>12</td> </tr> </table>	Risk Rating before control measures	Likelihood	5	Severity	5	Overall Risk	35	Risk Rating after control measures	Likelihood	3	Severity	4	Overall Risk	12	<p>Reducing Contact Time</p> <ul style="list-style-type: none"> • Service time will be shorter and will include Notices, Prayers, Reading and a Sermon • Congregation will be encouraged to leave the premises at the end of the Service • Mingling or Socialising before, during and after the Service will be discouraged on the premises <p>Singing</p> <ul style="list-style-type: none"> • Congregational singing will not take place in the meetings until advice changes • A band of up to 6 may play/sing if socially distanced from congregation and one another. Within band, individuals will stand side-to-side, not facing each other. • Recordings of singing/music may be used. During conversation time volume will be kept low. • Good ventilation will be ensured by opening doors and windows when possible. 	1 Oct 2020
Risk Rating before control measures		Likelihood	5													
		Severity	5													
	Overall Risk	35														
Risk Rating after control measures	Likelihood	3														
	Severity	4														
	Overall Risk	12														
<p>iv) Spread to other Contacts outside of GCB</p> <table border="1"> <tr> <td rowspan="3">Risk Rating before control measures</td> <td>Likelihood</td> <td>5</td> </tr> <tr> <td>Severity</td> <td>5</td> </tr> <tr> <td>Overall Risk</td> <td>35</td> </tr> </table> <table border="1"> <tr> <td rowspan="3">Risk Rating after control measures</td> <td>Likelihood</td> <td>4</td> </tr> <tr> <td>Severity</td> <td>2</td> </tr> <tr> <td>Overall Risk</td> <td>8</td> </tr> </table>	Risk Rating before control measures	Likelihood	5	Severity	5	Overall Risk	35	Risk Rating after control measures	Likelihood	4	Severity	2	Overall Risk	8	<p>Testing and Tracing</p> <ul style="list-style-type: none"> • A record of visitors each Sunday will be retained for 3 weeks: Name, contact phone, date, arrival time, departure time. • Records will be disposed of securely (shredded) • Privacy notice information will be on display setting out what the data will be used for etc • A Steward will register attendees on arrival • Consent can be withheld and individual may still attend. • Government guidance will be followed in the event of a local outbreak 	1 Oct 2020
Risk Rating before control measures		Likelihood	5													
		Severity	5													
	Overall Risk	35														
Risk Rating after control measures	Likelihood	4														
	Severity	2														
	Overall Risk	8														

<p>2. Individuals may feel excluded if they cannot attend the Service</p> <table border="1" data-bbox="100 326 533 418"> <tr> <td rowspan="3">Risk Rating before control measures</td> <td>Likelihood</td> <td>5</td> </tr> <tr> <td>Severity</td> <td>5</td> </tr> <tr> <td>Overall Risk</td> <td>35</td> </tr> </table> <table border="1" data-bbox="100 444 533 537"> <tr> <td rowspan="3">Risk Rating after control measures</td> <td>Likelihood</td> <td>4</td> </tr> <tr> <td>Severity</td> <td>2</td> </tr> <tr> <td>Overall Risk</td> <td>8</td> </tr> </table>	Risk Rating before control measures	Likelihood	5	Severity	5	Overall Risk	35	Risk Rating after control measures	Likelihood	4	Severity	2	Overall Risk	8	<ul style="list-style-type: none"> • Anyone who is symptomatic or self-isolating will not be allowed to attend • All adults will be encouraged to wear a face mask for the protection of others • Those who are 'at risk' will be encouraged to stay at home • Alternative ways to access the Reading and Sermon will be provided • Regular alternative 'contact' will be provided through fellowship or friendship groups e.g. socially distanced visits or phone calls 	<p>1 Oct 2020</p>
Risk Rating before control measures		Likelihood	5													
		Severity	5													
	Overall Risk	35														
Risk Rating after control measures	Likelihood	4														
	Severity	2														
	Overall Risk	8														
<p>3. Cross-contamination through the use of equipment touched by multiple users</p> <table border="1" data-bbox="100 743 533 836"> <tr> <td rowspan="3">Risk Rating before control measures</td> <td>Likelihood</td> <td>5</td> </tr> <tr> <td>Severity</td> <td>5</td> </tr> <tr> <td>Overall Risk</td> <td>35</td> </tr> </table> <table border="1" data-bbox="100 862 533 954"> <tr> <td rowspan="3">Risk Rating after control measures</td> <td>Likelihood</td> <td>3</td> </tr> <tr> <td>Severity</td> <td>3</td> </tr> <tr> <td>Overall Risk</td> <td>9</td> </tr> </table>	Risk Rating before control measures	Likelihood	5	Severity	5	Overall Risk	35	Risk Rating after control measures	Likelihood	3	Severity	3	Overall Risk	9	<ul style="list-style-type: none"> • Either: Bible passage will be printed on single-use paper, handed out whilst wearing gloves and people will be requested to take their copy home or dispose of in bins. OR: Bibles will be handed out and collected after the service whilst wearing gloves and will be quarantined for 72 hours between use. • PA team will wash/sanitise hands before <i>and</i> after setting up <i>and</i> taking down PA • PA desk will be wiped down before and after use • Music stands/lectern will not be shared or will be disinfected between users. • Microphones will be single use or wiped down with disinfectant between users • Music will not be shared between band members. Instead, they will bring and take home own copy • Drummers will bring their own sticks • Instruments will be cleaned before and after use. • No other items will be shared or passed around before, during or after the service • Items and equipment that have not been handled or touched for 72hours will be considered low risk for the spread of infection • Cash donation boxes will not be used. 	<p>1 Oct 2020</p>
Risk Rating before control measures		Likelihood	5													
		Severity	5													
	Overall Risk	35														
Risk Rating after control measures	Likelihood	3														
	Severity	3														
	Overall Risk	9														
<p>4. Spread of Covid-19 through sharing food and drink</p> <table border="1" data-bbox="100 1305 533 1398"> <tr> <td rowspan="3">Risk Rating before control measures</td> <td>Likelihood</td> <td>5</td> </tr> <tr> <td>Severity</td> <td>5</td> </tr> <tr> <td>Overall Risk</td> <td>35</td> </tr> </table>	Risk Rating before control measures	Likelihood	5	Severity	5	Overall Risk	35	<p>Communion</p> <ul style="list-style-type: none"> • Communion preparation will be done by one person who has washed their hands and is wearing gloves • Those distributing the bread and the cup will wash or sanitise their hands immediately before distribution and wear gloves. • Bread (or wafers) will be kept covered until distribution. It will be dropped into the hand. • Juice will be distributed in individual cups and distributed at 1m social distance • All utensils will be thoroughly washed before and after distribution or discarded if disposable 	<p>1 Oct 2020</p>							
Risk Rating before control measures		Likelihood	5													
		Severity	5													
	Overall Risk	35														

Risk Rating after control measures	Likelihood	2	Refreshments
	Severity	4	
	Overall Risk	8	
			<ul style="list-style-type: none"> No refreshments will be served on normal Sundays The kitchen will be out of bounds On some occasions individual pre-packaged drinks and snacks will be available for consumption

Environment – Back Hall – Children’s Church and other events

Risks Identified	Control Measures	Review Date														
<p>Covid-19 Transmission through: 1. Children gathering for Children’s church</p> <table border="1" style="width: 100%;"> <tr> <td rowspan="3">Risk Rating before control measures</td> <td>Likelihood</td> <td>5</td> </tr> <tr> <td>Severity</td> <td>5</td> </tr> <tr> <td>Overall Risk</td> <td>25</td> </tr> </table> <table border="1" style="width: 100%;"> <tr> <td rowspan="3">Risk Rating after control measures</td> <td>Likelihood</td> <td>2</td> </tr> <tr> <td>Severity</td> <td>2</td> </tr> <tr> <td>Overall Risk</td> <td>4</td> </tr> </table> <p>Back Hall capacity estimated at 40 people when all distanced 2m apart</p>	Risk Rating before control measures	Likelihood	5	Severity	5	Overall Risk	25	Risk Rating after control measures	Likelihood	2	Severity	2	Overall Risk	4	<ul style="list-style-type: none"> Those with symptoms/positive test must stay at home – see main church room wording. The environment will be prepared and cleaned before and after use using a cleaning check list Rooms will be well ventilated, with open doors when safe. Children will be lined-up in groups on the main stage then escorted into the hall by their group leader Groups will remain socially distanced from one another throughout children’s church Groups will not exceed 15 Everyone will hand sanitize at entry and exit. Supervision will ensure good sanitizing. Tissues and bins will be available and children encouraged to ‘catch it, bin it, kill it’. Attendance Registers will be kept as usual. Children will be allocated their own bible and pencil case with pencil, pens, glue and scissors There will be no sharing of equipment Children will be seated at tables side-by-side or greater than 1m apart if face-to-face. Leaders will remain at 2m social distance from each other It is understood that leaders will not be able to social distance from the children in their group. Social distance will be maintained where possible Groups will be escorted back to the Main Hall at the end of the service. Children will return to their family bubble Unwell children will be separated and parents requested to take them home. The area will be cleaned Teachers and parents will be given information on procedures and safety measures to be followed. SEN children will have risk assessment and appropriate adaptations to guidance. 	<p>13 Sept 2020</p>
Risk Rating before control measures		Likelihood	5													
		Severity	5													
	Overall Risk	25														
Risk Rating after control measures	Likelihood	2														
	Severity	2														
	Overall Risk	4														

<p>Covid-19 Transmission through: 2. Other events held in the hall</p> <table border="1" data-bbox="100 332 533 430"> <tr> <td rowspan="3">Risk Rating before control measures</td> <td>Likelihood</td> <td>5</td> </tr> <tr> <td>Severity</td> <td>5</td> </tr> <tr> <td>Overall Risk</td> <td>35</td> </tr> </table> <table border="1" data-bbox="100 462 533 560"> <tr> <td rowspan="3">Risk Rating after control measures</td> <td>Likelihood</td> <td>4</td> </tr> <tr> <td>Severity</td> <td>3</td> </tr> <tr> <td>Overall Risk</td> <td>12</td> </tr> </table>	Risk Rating before control measures	Likelihood	5	Severity	5	Overall Risk	35	Risk Rating after control measures	Likelihood	4	Severity	3	Overall Risk	12	<ul style="list-style-type: none"> • General guidance outlined under the Main Church Building will be followed including cleaning, ventilation, social distancing, signage, hand-sanitisation, masks (other than for main speakers) • The following changes to the main guidance will apply: • One way entry and exit: Entry will be carpark gate, exit will be Huxbear Street • A maximum of 40 attendees will be allowed • Individual and pre-packaged drinks and snacks may be available for consumption by attendees 	<p>1 Oct 2020</p>
Risk Rating before control measures		Likelihood	5													
		Severity	5													
	Overall Risk	35														
Risk Rating after control measures	Likelihood	4														
	Severity	3														
	Overall Risk	12														
<p>Covid-19 Transmission through: 3. Onyx and CIA Youth Groups meeting in the hall</p> <table border="1" data-bbox="100 820 533 917"> <tr> <td rowspan="3">Risk Rating before control measures</td> <td>Likelihood</td> <td>5</td> </tr> <tr> <td>Severity</td> <td>5</td> </tr> <tr> <td>Overall Risk</td> <td>35</td> </tr> </table> <table border="1" data-bbox="100 950 533 1047"> <tr> <td rowspan="3">Risk Rating after control measures</td> <td>Likelihood</td> <td>4</td> </tr> <tr> <td>Severity</td> <td>3</td> </tr> <tr> <td>Overall Risk</td> <td>12</td> </tr> </table> <p>The risk rating in leaders' homes after control measures have been put in place is the same as in the church hall.</p>	Risk Rating before control measures	Likelihood	5	Severity	5	Overall Risk	35	Risk Rating after control measures	Likelihood	4	Severity	3	Overall Risk	12	<ul style="list-style-type: none"> • General guidance outlined under the Main Church Building will be followed including cleaning, ventilation, social distancing, signage, hand-sanitisation • The following changes/additions to the main guidance will apply: • One way entry and exit: Entry will be carpark gate, exit will be Huxbear Street • Onyx and CIA groups will usually not mix but stay in separate bubbles* • Groups will not exceed 15* • Masks are not required* • Attendance Registers will be kept as usual* • There will be no sharing of equipment • Tissues and bins will be available and children encouraged to 'catch it, bin it, kill it'* • Leaders/Teachers will remain at 2m Social distance from each other* • Teachers and parents will be given information on procedures and safety measures to be followed* • Individual and pre-packaged drinks and snacks may be available for consumption by attendees <p>Note: for Onyx and CIA meeting in leaders' homes, items marked with * above are to be followed. In addition, the following precautions will be taken:</p> <ul style="list-style-type: none"> • Areas to be used will be cleaned before and after the meeting. It is understood that cleaning the home environment is unlikely to be as easy as the church. Particular attention will be paid to frequently touched surfaces and toilets • Where possible, doors and windows will be kept open throughout meeting • Everyone will be asked to use hand sanitiser on arrival and exit • Food and drink may be provided. This will be individually packaged where possible. If using serving dishes and utensils to share dishes (e.g. hot foot), pay particular attention to hygiene. 	<p>13 Sept 2020</p>
Risk Rating before control measures		Likelihood	5													
		Severity	5													
	Overall Risk	35														
Risk Rating after control measures	Likelihood	4														
	Severity	3														
	Overall Risk	12														

Environment: rear toilets

Risks Identified	Control Measures	Review Date														
<p>Risk of transmission at pinch point outside toilets</p> <table border="1" style="width: 100%; border-collapse: collapse;"> <tr> <td rowspan="3" style="width: 20%;">Risk Rating before control measures</td> <td style="width: 20%;">Likelihood</td> <td style="width: 10%; text-align: center;">5</td> </tr> <tr> <td>Severity</td> <td style="text-align: center;">5</td> </tr> <tr> <td>Overall Risk</td> <td style="text-align: center; background-color: #f08080;">35</td> </tr> </table> <table border="1" style="width: 100%; border-collapse: collapse;"> <tr> <td rowspan="3" style="width: 20%;">Risk Rating after control measures</td> <td style="width: 20%;">Likelihood</td> <td style="width: 10%; text-align: center;">3</td> </tr> <tr> <td>Severity</td> <td style="text-align: center;">4</td> </tr> <tr> <td>Overall Risk</td> <td style="text-align: center; background-color: #90ee90;">12</td> </tr> </table>	Risk Rating before control measures	Likelihood	5	Severity	5	Overall Risk	35	Risk Rating after control measures	Likelihood	3	Severity	4	Overall Risk	12	<ul style="list-style-type: none"> Toilet doors will be wedged open Use of toilets will be restricted to Children’s Church or Events held in Back Hall Socially distanced access is marked out via back hall. Use of toilets will be restricted to One family/bubble at a time: ‘One in’ ‘One out’ A clear area for social distanced queuing is marked out A hand sanitiser station will be available 	<p>1 Oct 2020</p>
Risk Rating before control measures		Likelihood	5													
		Severity	5													
	Overall Risk	35														
Risk Rating after control measures	Likelihood	3														
	Severity	4														
	Overall Risk	12														

Environment Side Hall – thoroughfare and teaching space

Risks Identified	Proposed Action to be taken to mitigate risks at GCB	Review Date														
<p>Risk of transmission due to area being small and multi-use (toilet queue, exit thoroughfare and teaching space)</p> <table border="1" style="width: 100%; border-collapse: collapse;"> <tr> <td rowspan="3" style="width: 20%;">Risk Rating before control measures</td> <td style="width: 20%;">Likelihood</td> <td style="width: 10%; text-align: center;">5</td> </tr> <tr> <td>Severity</td> <td style="text-align: center;">5</td> </tr> <tr> <td>Overall Risk</td> <td style="text-align: center; background-color: #f08080;">35</td> </tr> </table> <table border="1" style="width: 100%; border-collapse: collapse;"> <tr> <td rowspan="3" style="width: 20%;">Risk Rating after control measures</td> <td style="width: 20%;">Likelihood</td> <td style="width: 10%; text-align: center;">3</td> </tr> <tr> <td>Severity</td> <td style="text-align: center;">3</td> </tr> <tr> <td>Overall Risk</td> <td style="text-align: center; background-color: #90ee90;">9</td> </tr> </table> <p>Side Hall capacity estimated at 8 people when all distanced 2m apart</p>	Risk Rating before control measures	Likelihood	5	Severity	5	Overall Risk	35	Risk Rating after control measures	Likelihood	3	Severity	3	Overall Risk	9	<ul style="list-style-type: none"> The room is subdivided into an area for toilet queuing and a one way exit into the carpark (see floor plan) Hand Sanitising Stations are available by carpark door exit and outside toilets Socially distanced floor markings are present A table and chairs with a maximum bubble of 1 leader and 7 children or 2 leaders and 6 children will be available for use when the area is not being used as an exit or for toilet queuing. Any teaching of children will follow the guidelines for ‘Children gathering for Children’s church’ above. 	<p>1 Oct 2020</p>
Risk Rating before control measures		Likelihood	5													
		Severity	5													
	Overall Risk	35														
Risk Rating after control measures	Likelihood	3														
	Severity	3														
	Overall Risk	9														

Environment: Huxbear Upper Hall – creche for 0-4 year-olds

Risks Identified	Proposed Action to be taken to mitigate risks at GCB	Review Date																		
<p>1. Providing a creche for 0-4 year-olds may increase Infection spread through:</p> <p>i) Person to person contact ii) Toileting iii) Shared toys iv) Airborne v) Narrow ‘two way’ stairway creating a ‘pinch point’</p> <table border="1" style="width: 100%; border-collapse: collapse; margin-bottom: 10px;"> <tr> <td style="text-align: right;">Risk Rating before control measures</td> <td style="text-align: center;">Likelihood</td> <td style="text-align: center;">5</td> </tr> <tr> <td></td> <td style="text-align: center;">Severity</td> <td style="text-align: center;">5</td> </tr> <tr> <td></td> <td style="text-align: center;">Overall Risk</td> <td style="text-align: center; background-color: red; color: white;">35</td> </tr> </table> <table border="1" style="width: 100%; border-collapse: collapse;"> <tr> <td style="text-align: right;">Risk Rating after control measures</td> <td style="text-align: center;">Likelihood</td> <td style="text-align: center;">3</td> </tr> <tr> <td></td> <td style="text-align: center;">Severity</td> <td style="text-align: center;">2</td> </tr> <tr> <td></td> <td style="text-align: center;">Overall Risk</td> <td style="text-align: center; background-color: green; color: white;">6</td> </tr> </table> <p>Side Hall capacity estimated at 16 people when all distanced 2m apart</p>	Risk Rating before control measures	Likelihood	5		Severity	5		Overall Risk	35	Risk Rating after control measures	Likelihood	3		Severity	2		Overall Risk	6	<ul style="list-style-type: none"> Those with symptoms/positive test must stay at home – see Main Hall guidelines The environment will be prepared and cleaned on arrival and exit, using a cleaning check list Parents will stagger their drop off of children to avoid congestion on stairs All adults will hand sanitize at entry and exit and assist children who are able Tissues and bins will be available and children encouraged to ‘catch it, bin it, kill it’. Numbers (adults and children) will not exceed 16 Safeguarding ratios of adults to children will be maintained Toys and equipment may be shared but these will be cleaned or put ‘out of action’ for 72+ hours between each Creche session Recorded music may be used for dance and movement A small class with one leader and up to 4 children may meet in the classroom Leaders will remain at 2m Social distance from other leaders Children under 5 are not expected to socially distance Attendance Registers will be kept as usual. Where possible windows will be opened to increase ventilation Unwell children will be separated and parents requested to take them home. The area will be cleaned Teachers and parents will be given information on procedures and safety measures to be followed. <p>Toileting</p> <ul style="list-style-type: none"> Toilet doors will be kept open Use of toilets will be restricted to one child and one leader at a time Hand-washing will be supervised <p>Stairway</p> <ul style="list-style-type: none"> Social distance markings are in place Parents ‘drop off’ will be staggered: one in and one out No passing will happen on the stairs 	<p>13 Sept 2020</p>
Risk Rating before control measures	Likelihood	5																		
	Severity	5																		
	Overall Risk	35																		
Risk Rating after control measures	Likelihood	3																		
	Severity	2																		
	Overall Risk	6																		

Environment: Prayer Room

Risks Identified	Control Measures	Review Date									
<p>1-2-1 English teaching with D and G. Risk for vulnerable adults involved</p> <table border="1" style="width: 100%; border-collapse: collapse;"> <tr> <td style="width: 15%;">Risk Rating before control measures</td> <td style="width: 15%;">Likelihood</td> <td style="width: 10%;">5</td> </tr> <tr> <td></td> <td>Severity</td> <td>5</td> </tr> <tr> <td></td> <td>Overall Risk</td> <td style="background-color: #f08080;">35</td> </tr> </table>	Risk Rating before control measures	Likelihood	5		Severity	5		Overall Risk	35	<ul style="list-style-type: none"> Cancel this activity until further notice The Prayer Lounge is “out of bounds” as it is currently being used for storage 	1 Oct 2020
Risk Rating before control measures	Likelihood	5									
	Severity	5									
	Overall Risk	35									

Environment: Kitchen – refreshments

Risks Identified	Proposed Action to be taken to mitigate risks at GCB	Review Date									
<p>Serving Light Refreshments for adults and children</p> <table border="1" style="width: 100%; border-collapse: collapse;"> <tr> <td style="width: 15%;">Risk Rating before control measures</td> <td style="width: 15%;">Likelihood</td> <td style="width: 10%;">5</td> </tr> <tr> <td></td> <td>Severity</td> <td>5</td> </tr> <tr> <td></td> <td>Overall Risk</td> <td style="background-color: #f08080;">35</td> </tr> </table>	Risk Rating before control measures	Likelihood	5		Severity	5		Overall Risk	35	<ul style="list-style-type: none"> No refreshments will be served before, after or during the service until further notice Kitchen will remain Out of bounds until further notice 	1 Oct 2020
Risk Rating before control measures	Likelihood	5									
	Severity	5									
	Overall Risk	35									

Environment: car park

Risks Identified	Control Measures	Review Date																		
<p>Potential area for after-church socialising which would compromise social distancing</p> <table border="1" style="width: 100%; border-collapse: collapse;"> <tr> <td style="width: 15%;">Risk Rating before control measures</td> <td style="width: 15%;">Likelihood</td> <td style="width: 10%;">5</td> </tr> <tr> <td></td> <td>Severity</td> <td>5</td> </tr> <tr> <td></td> <td>Overall Risk</td> <td style="background-color: #f08080;">35</td> </tr> </table> <table border="1" style="width: 100%; border-collapse: collapse;"> <tr> <td style="width: 15%;">Risk Rating after control measures</td> <td style="width: 15%;">Likelihood</td> <td style="width: 10%;">4</td> </tr> <tr> <td></td> <td>Severity</td> <td>2</td> </tr> <tr> <td></td> <td>Overall Risk</td> <td style="background-color: #90ee90;">8</td> </tr> </table>	Risk Rating before control measures	Likelihood	5		Severity	5		Overall Risk	35	Risk Rating after control measures	Likelihood	4		Severity	2		Overall Risk	8	<ul style="list-style-type: none"> Direct family/bubbles to exit main meeting via the carpark side door Encourage family/ bubbles to adhere to social distancing even whilst outside Ensure that everyone is requested to leave the premises at social distance by 5.15pm 	1 Oct 2020
Risk Rating before control measures	Likelihood	5																		
	Severity	5																		
	Overall Risk	35																		
Risk Rating after control measures	Likelihood	4																		
	Severity	2																		
	Overall Risk	8																		

CPBC COVID LAYOUT - DRAFT 1

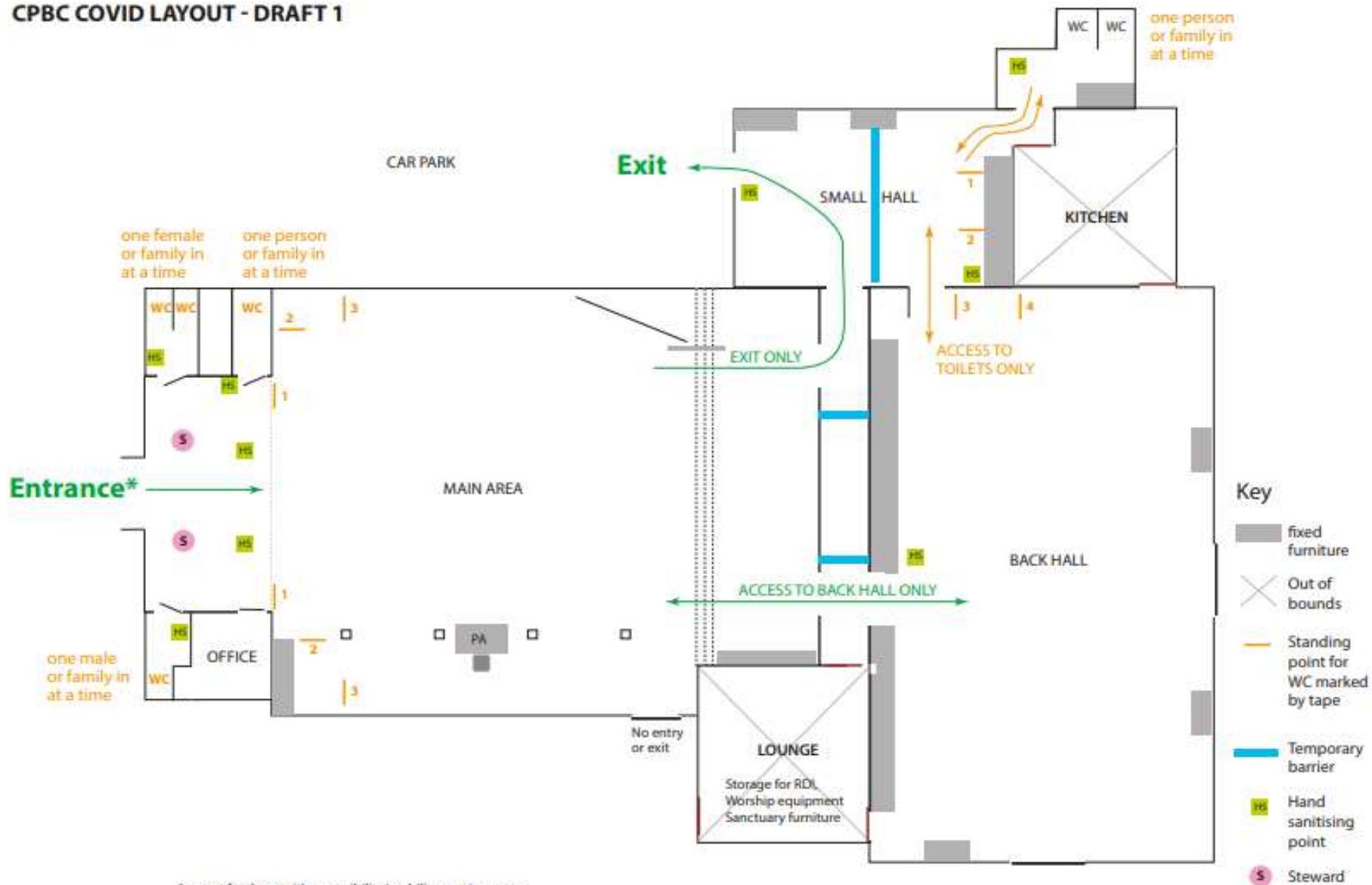

*except for those with accessibility/mobility requirements

CPBC Huxbear Hall – Approximate and not to scale

